

# Fig. 7901 Pneumatic actuator valve

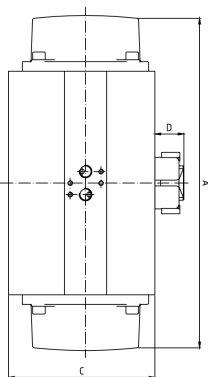

**econ®**

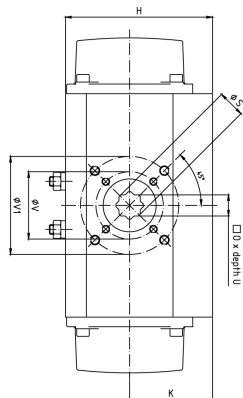

The ECON spring return pneumatic actuator can be supplied as spring-to-close or spring-to-open. Apart from the position indicator, all versions are without any external moving parts. This makes these actuators safe in operation, easy to install and virtually maintenance-free. With the compact rack and pinion design and the use of aluminium parts, these actuators are lightweight and compact.

### Features

- Transmission: Quarter turn
- Material: Aluminium
- Connection installation flange: ISO 5211
- Connection top flange: NAMUR (VDI/VDE 3845)
- Active principle: Single-acting
- Signal pressure: 6 bar
- Connection, air supply: NAMUR (VDI/VDE 3845)

### Pressure and Temp Range

- Temperature range: -20 tot +80 °C

### Dimensions

Type	A	C	D	H	K	O	U	V	V1
	[mm]								
ASR20	163	66	30	76	48	9	10	36	50
ASR40	195	85	30	91	56	14	12	42	---
ASR80	217	107	30	111	66	17	19	50	70
ASR130	258	117	30	122	71	17	22	50	70
ASR200	299	135	30	136	78	17	23	70	102
ASR300	349	152	30	153	86	17	24	70	102
ASR500	397	169	30	173	96	22	32	102	---
ASR850	473	191	30	192	106	27	39	102	125
ASR1200	560	219	30	213	116	36	48	102	140
ASR1750	601	250	30	243	131	36	50	140	---
ASR2100	702	283	30	277	148	46	50	165	---
ASR2500	738	353	30	356	178	46	58	165	---
ASR4000	940	404	30	415	213	55	60	165	254

### Material Specifications

Component	Material	EN en/of (DIN)	W.nr.
Body	Aluminium		
Covers	Aluminium + Epoxy		
Drive shaft	Steel (ENP)		
Cover bolts	Stainless steel		

### Order Information

Stock	Article No.	Order code	Dimension	Clutch single acting start air [Nm]	Clutch single acting spring end [Nm]
S	EC0790100BSR0020	593053	ASR20	12	9
S	EC0790100CSR0040	593054	ASR40	26	17
S	EC0790100ESR0080	593057	ASR80	51	30
S	EC0790100ESR0130	593058	ASR130	80	45
S	EC0790100FSR0200	593059	ASR200	113	73
S	EC0790100GSR0300	593060	ASR300	190	119
S	EC0790100HSR0500	593061	ASR500	283	177
S	EC0790100ISR0850	593062	ASR850	488	271
S	EC0790100JSR1200	593063	ASR1200	698	400
S	EC0790100KSR1750	593064	ASR1750	877	631

This product information sheet has been formulated with the greatest care, but no rights can be derived from it. Subject to change.

**Order Information**

Stock	Article No.	Order code	Dimension	Clutch single acting start air [Nm]	Clutch single acting spring end [Nm]
	EC0790100LSR2100	593065	ASR2100	1202	970
	EC0790100LSR2500	593066	ASR2500	2454	1184
	EC0790100MSR4000	593067	ASR4000	3312	1769